

# XEBEC®

ISO 9001 Certified

XEBEC products are manufactured in a plant certified by ISO9001, the international standard of quality control and assurance.

# Ceramic Fiber Mounted Point (Air Type)

Ceramic Fiber Stones

**NEW!**

- Can be used with high speed rotating tools (Air type).
- No cracking, no chipping!
- No clogging!
- Ideal for improving surface finishes!

## Features

- Cutting edges are continually exposed over the entire surface thanks to self sharpening alumina fiber ceramic rod.
- Works great for any material up to 57HRC such as Aluminum and Stainless steel.
- Efficient removal of burrs with base thickness up to 0.2mm.



※ Please be careful with similar products.

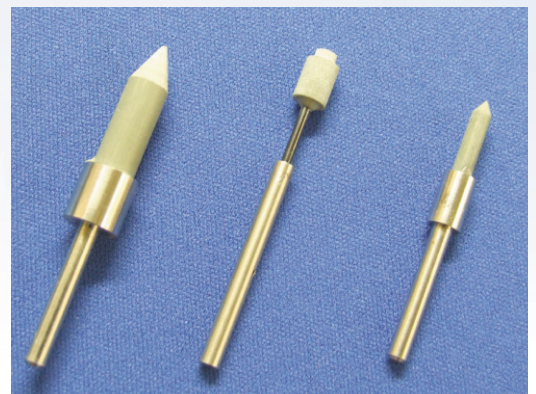

Shape the tip for specific applications

## Applications

Deburring of stainless steel groove

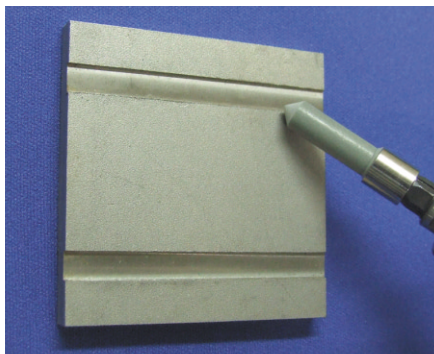

Breaking edge of steel workpiece

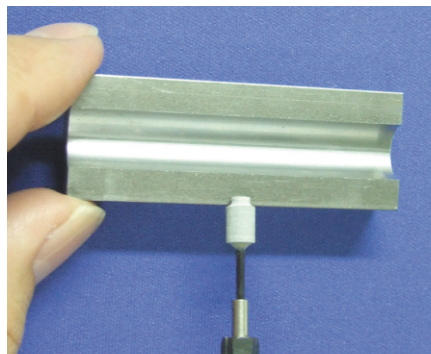

Chamfering of aluminum workpiece





# Ceramic Fiber Mounted Point (Air Type)

## AX-PM-5RF

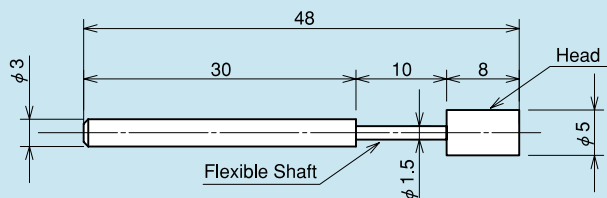

### Operation speed, up to 30,000 min<sup>-1</sup>

- Flexible shaft allows soft contact with the work-piece.
- Suitable for processing narrow area, thanks to the thin shaft (φ1.5mm).
- Cutting edges are exposed to entire surface.

## AX-PM-3R

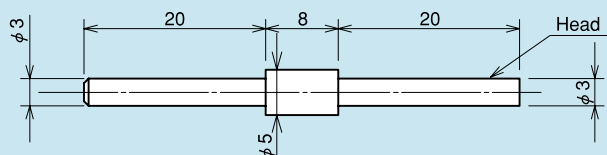

### Operation speed, up to 60,000 min<sup>-1</sup>

- Head is made entirely of Ceramic Fiber Stone with no inner shaft; eliminates wasted material.
- Cutting edges are exposed to entire surface.

## AX-PM-6T

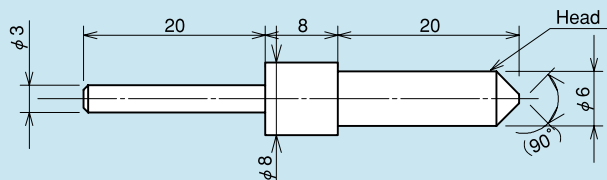

### Operation speed, up to 60,000 min<sup>-1</sup>

- No core metal is used and the tool head: made of Ceramic Fiber Stone can be used up all.
- Cutting edges are exposed to entire surface.

## Product code and specification

| Product code | Head Diameter | Head Length | Equivalent Grit | Shank size |
|--------------|---------------|-------------|-----------------|------------|
| AX-PM-5RF    | φ5mm          | 8mm         | #220            | φ3mm×30mm  |
| AX-PM-3R     | φ3mm          | 20mm        | #220            | φ3mm×20mm  |
| AX-PM-6T     | φ6mm          | 20mm        | #220            | φ3mm×20mm  |

\* All tools can be used with low speed rotating tools (electronic type).

## Precaution in use

### Pre-operation inspection

- When mounting on a rotating tool, insert the shaft into the end of the chuck, then secure it tightly.
- Conduct a test run for 1 minute or more before starting the operation and 3 minutes or more after changing a tool to confirm if there is any abnormality including vibration and looseness in the mounting place of the tool. Even if there is no abnormal condition observed in the test run, stop the use immediately in case any abnormality, such as vibration is observed while using the tool.
- Do not exceed the maximum revolutions for use.
- Do not use the tool under unreasonable angle and excessive pressure.
- Do not use the tool in any place with risk of fire and explosion.
- Do not grind or fabricate the shaft.

### Safety measures for operators

- Wear the protective equipment, such as protective goggles, gloves and masks all the time while operating the tool. Wear long-sleeved clothes and tighten the cuffs to protect your skin.
- Rotation of the tool will produce grinding dust from the part where the tool is applied and scatter the grinding dust around, so collect the dust with dust collector, etc.
- To avoid any danger caused by scattering of broken pieces or grinding dust from the tool while operating, enclose the working area with a safeguard to prohibit any person from entering into the dangerous area except the operator, or instruct any person working around the working area to wear the protective equipment.

### Warning

- Follow the precautions in use and safety measures for operators above without fail. If you fail to observe them, broken pieces of the tool or grinding dust may stick into your skin, or at worst stick into your eyes, causing blindness.

Please visit our homepage for details. — URL <http://www.xebec-tech.co.jp>

**XEBEC®** XEBEC TECHNOLOGY CO.,LTD.

Head Office 4-3-3 Koujimachi, Chiyoda-ku, Tokyo, Japan  
Phone. +81-3-3239-3481 FAX. +81-3-5211-8964  
U R L <http://www.xebec-tech.co.jp>  
E-mail [info@xebec-tech.co.jp](mailto:info@xebec-tech.co.jp)

Factory and R/D 4061-1 Minami-Minowa-mura, Kamiina-gun, Nagano, Japan  
Phone. +81-265-73-1523 FAX. +81-265-73-0375

Your order